



THEATRO  
SÃO PEDRO



Opened in January 16, 1917, Theatro São Pedro is one of the most important music venues in São Paulo and Brazil. Originally conceived as a drama theater, Theatro São Pedro went through several phases, working as a movie theater from the 1920s to the 1960s, and hosting plays again in the 1960s and 1970s, becoming an important center for political and cultural resistance during the military dictatorship. Landmarked as a historical and cultural heritage site in São Paulo in 1984, Theatro São Pedro went through an extensive renovation and was reopened in 1998 as a music theater. In 2010, stressing its new calling, the Theatro São Pedro Orchestra, the fixed corps of Theatro São Pedro, was created. Throughout the years, it became notable for the artistic quality of its performances, and is currently acknowledged as one of the main opera theaters in Brazil.











Lobby

Dinorá de  
Carvalho  
Room

Mezzanine

Dressing  
Rooms

- 1 individual dressing room
- 2 dressing rooms for 2 people each
- 3 dressing rooms for 6 people each

Located in the district of Barra Funda, downtown São Paulo, Theatro São Pedro is 200 meters away from the Marechal Deodoro subway (red line) station. The theater has a concert hall with 636 seats, lobby, mezzanine, dressing rooms, and the Dinorá de Carvalho room (for rehearsals and other events).









Performance  
hall

**636**  
seats

Access ramp  
and adapted  
bathrooms on the  
main floor

Main Floor

3 areas for  
People with  
Disabilities  
(in wheelchair)  
and 3 for their  
chaperones

**402**  
seats

# Ground Floor

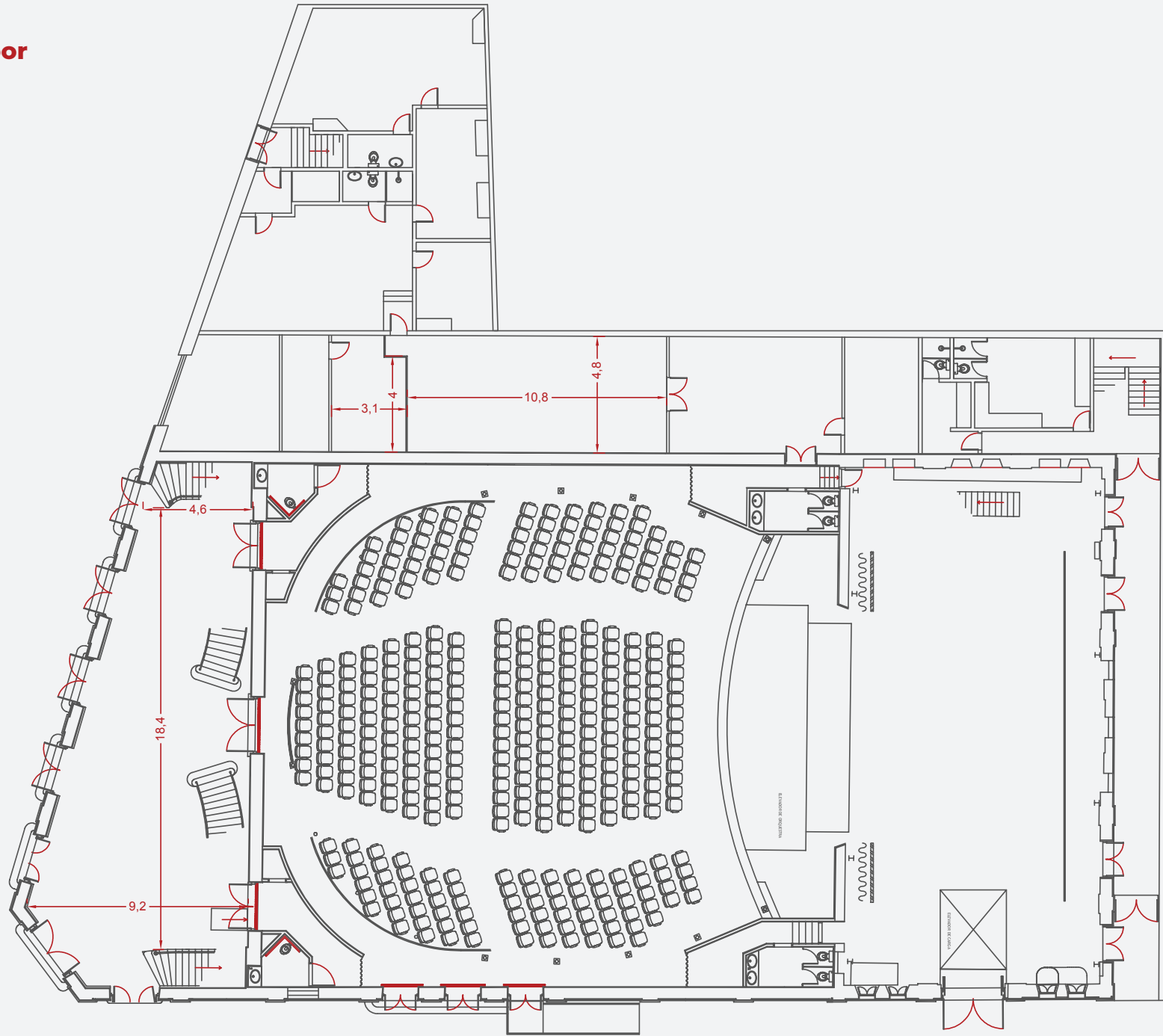





1<sup>st</sup> Balcony

**110**  
seats



# 1<sup>st</sup> Balcony

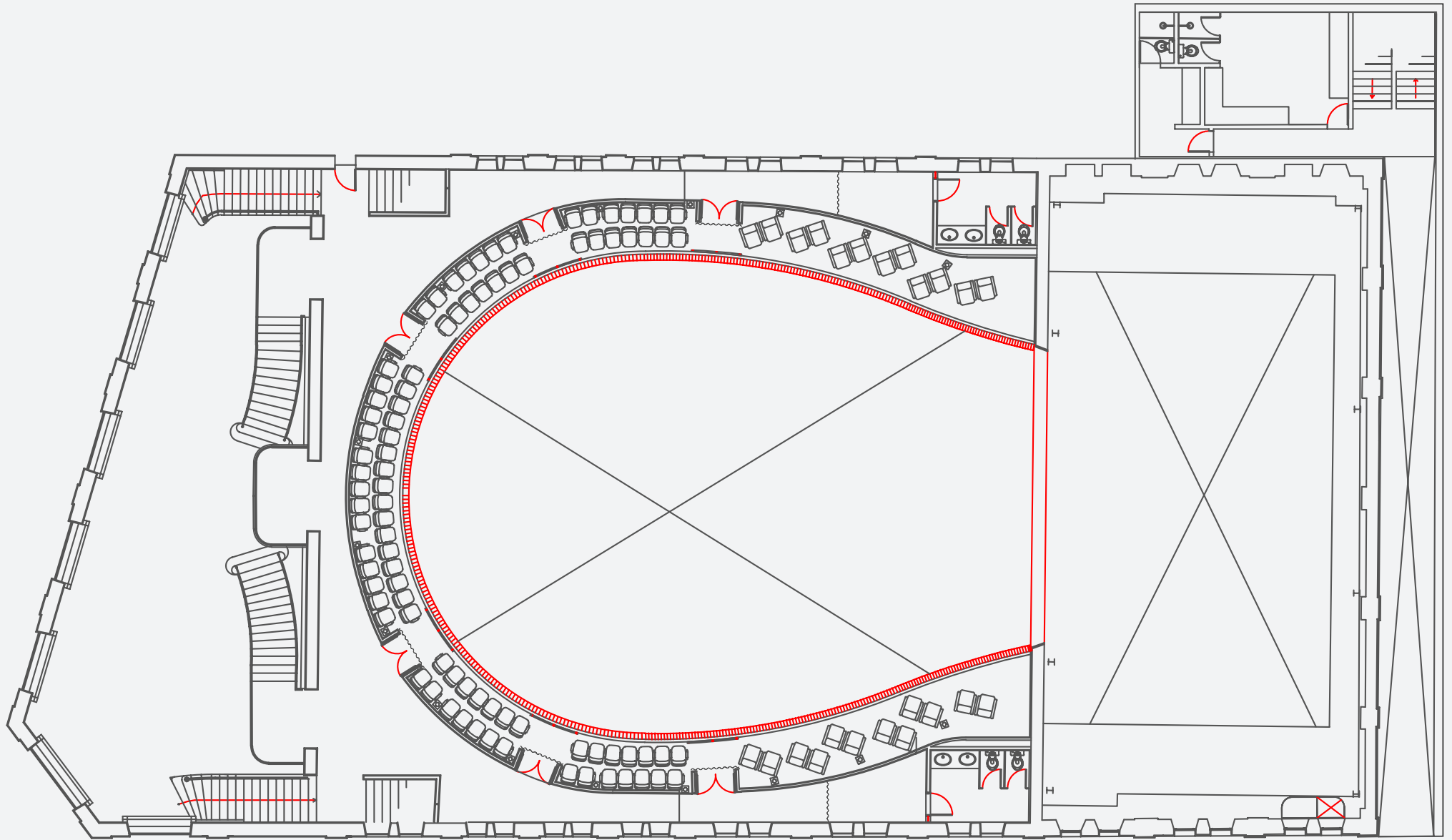





2<sup>nd</sup>  
Balcony

**124**  
seats



## 2<sup>nd</sup> Balcony

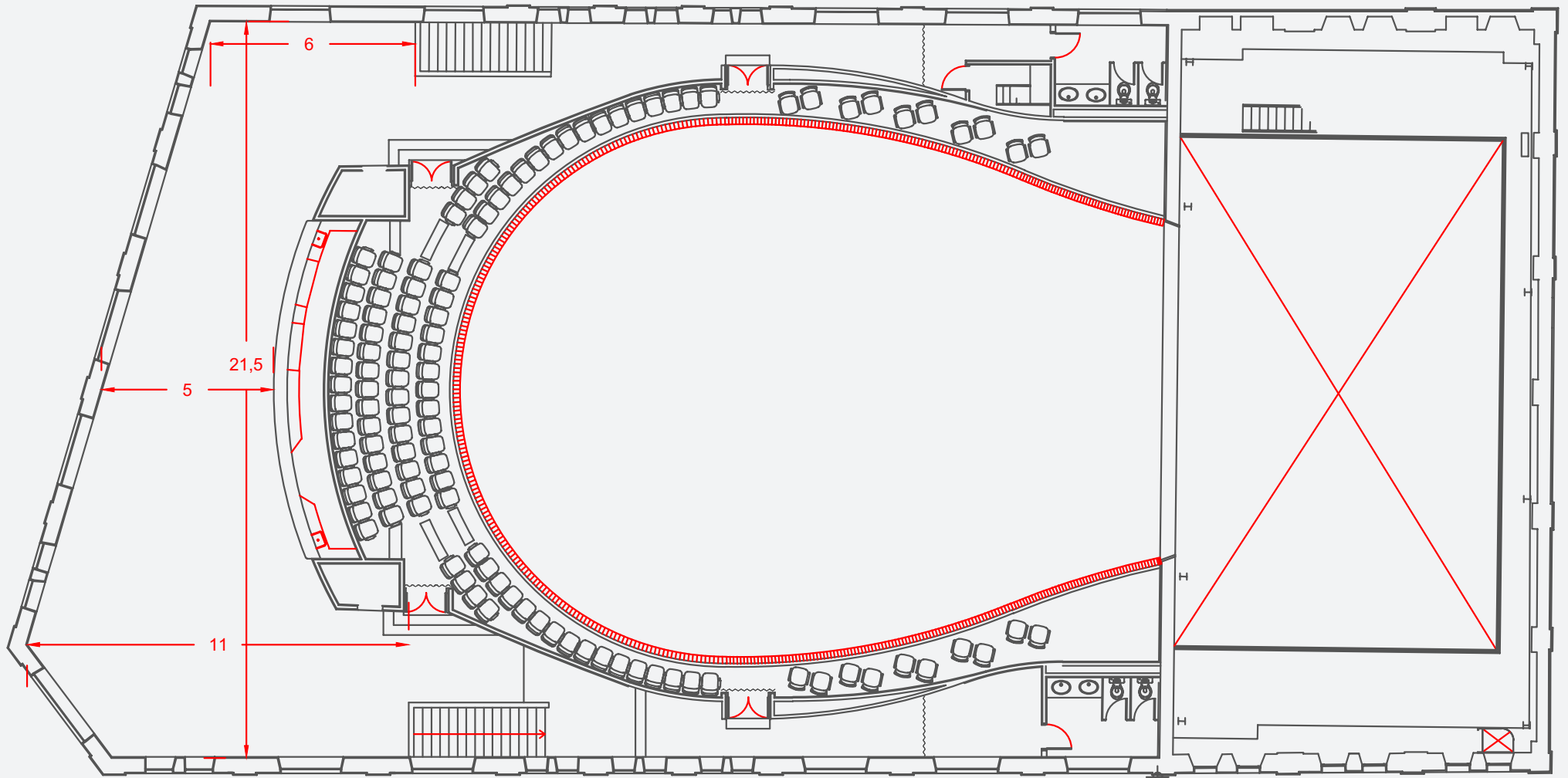





stage

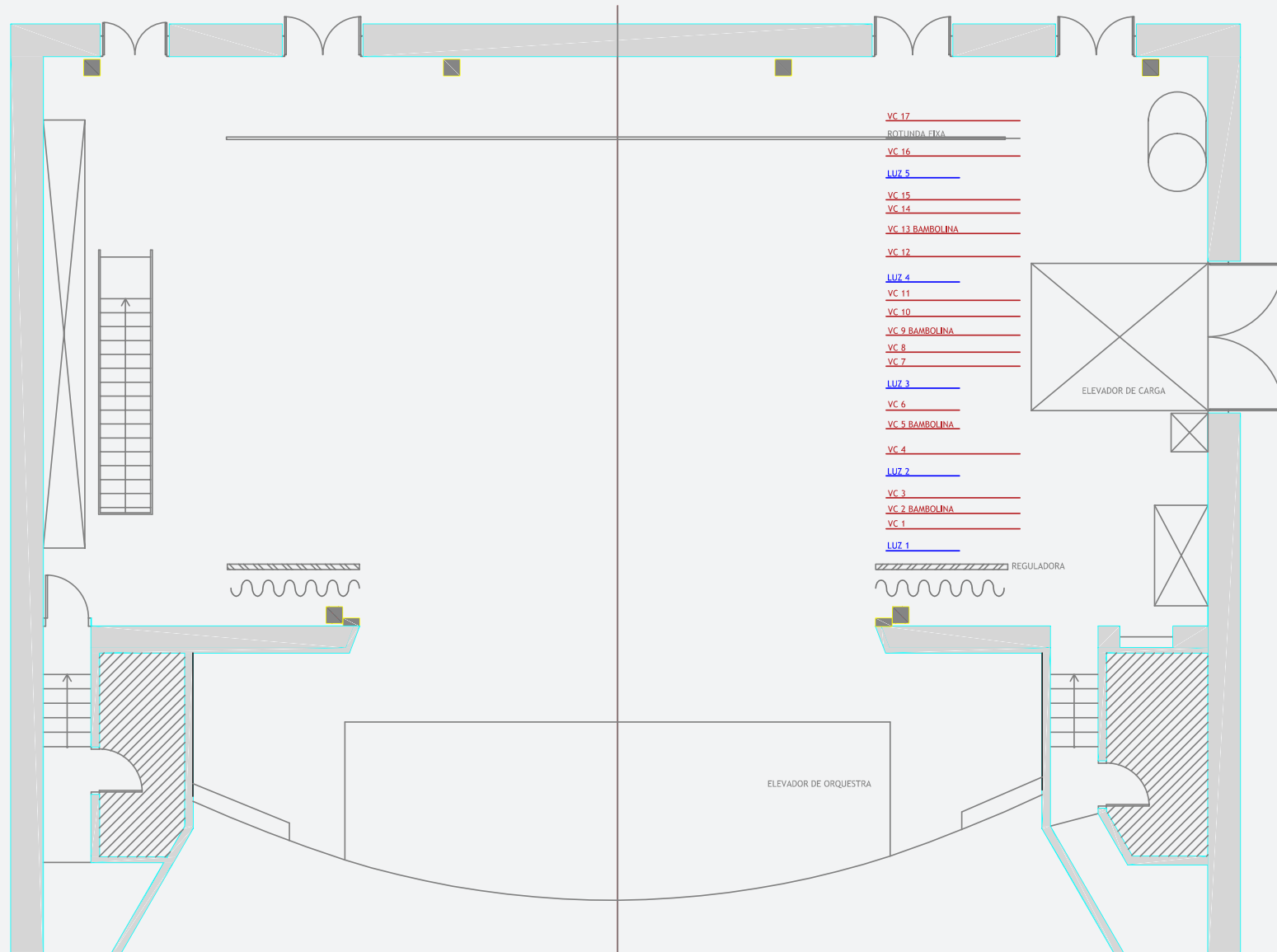



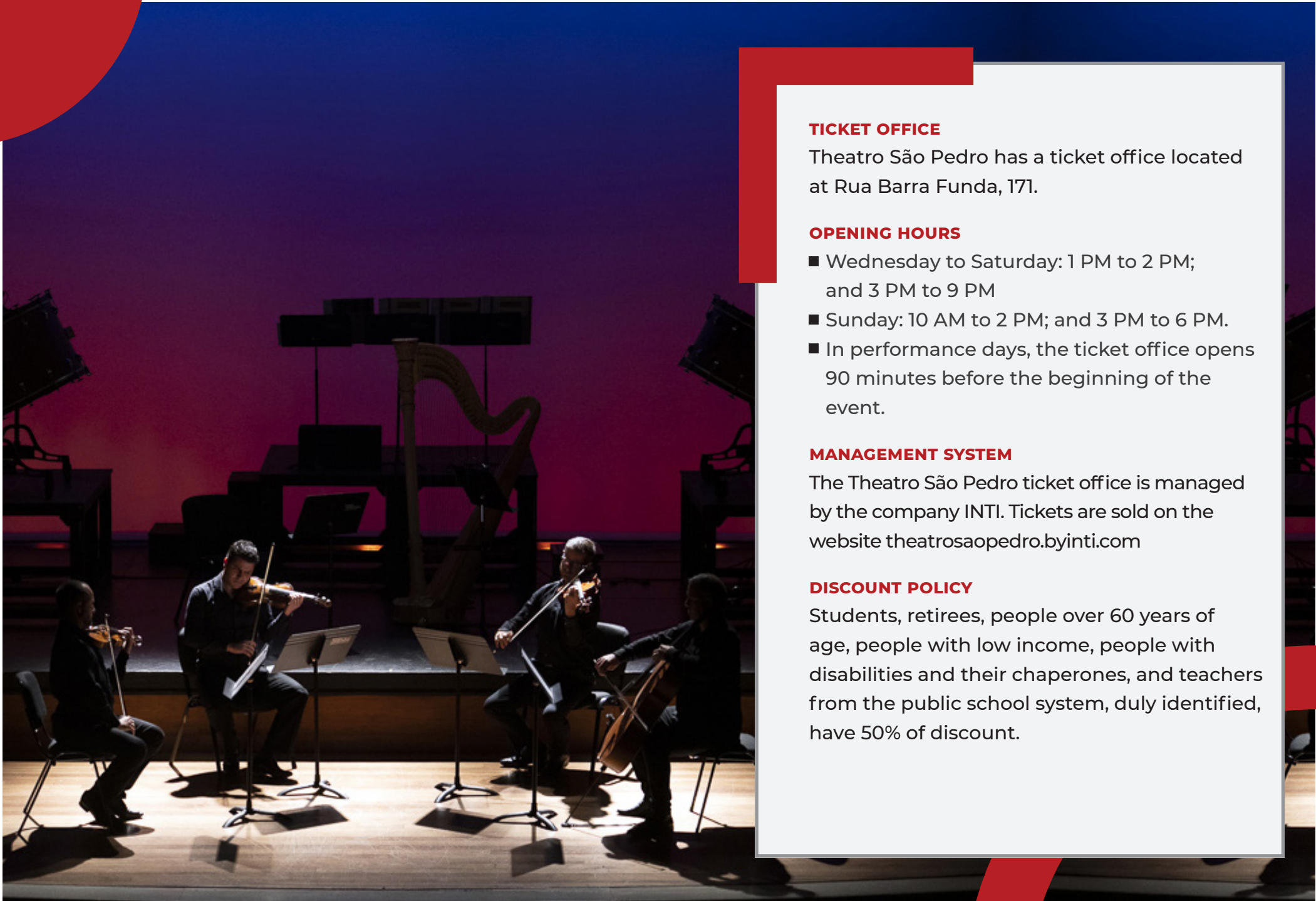

#### **TICKET OFFICE**

Theatro São Pedro has a ticket office located at Rua Barra Funda, 171.

#### **OPENING HOURS**

- Wednesday to Saturday: 1 PM to 2 PM; and 3 PM to 9 PM
- Sunday: 10 AM to 2 PM; and 3 PM to 6 PM.
- In performance days, the ticket office opens 90 minutes before the beginning of the event.

#### **MANAGEMENT SYSTEM**

The Theatro São Pedro ticket office is managed by the company INTI. Tickets are sold on the website [theatrosaopedro.byinti.com](http://theatrosaopedro.byinti.com)

#### **DISCOUNT POLICY**

Students, retirees, people over 60 years of age, people with low income, people with disabilities and their chaperones, and teachers from the public school system, duly identified, have 50% of discount.





**TECHNICAL**  
**INFORMATION**



### STAGE

- Italian style
- Floor: Wooden Boards
- Width: 18.35 m
- Depth: 10.12 m
- Fly Loft height: 12 m

### DOWNSTAGE

- Width: 9.65 m
- Height: 7.60 m
- Leg drops (standard):
- Width: 9.60 m
- Height: 6 m

### PROSCENIUM

- Width: 15.87 m
- Length: 1.79 m

### ORCHESTRA ELEVATOR

- Width: 10.17 m
- Length: 3.33 m

### ORCHESTRA PIT

- Width: 7 m
- Length: 7.93 m

### GRID

- Pin bar and Tuning bar

### FLY LOFT

- Space for circulation over the fly loft
- Reeling system – iron and wood

- 05 Fly bars - electric
- 17 Scenery bars – manual

**Note:** lighting bars cannot be used as scenery bars

### SCENIC CURTAINS

- 1 Fixed Backdrop – horizontal opening
- 4 Drapes
- 8 Legs - fly system
- 1 black tulle 12m x 6m
- 1 white tulle 12m x 6m
- 1 white tulle 10m x 6m
- 1 white PVC – 13.4m x 6m

### SHELVES

- 75 Black shelves
- 70 Wooden shelves

### CANOPIES

- Double: 47 canopies 42 bi-volt sources
- Individual: 40 canopies

### CHAIRS/STOOLS

- 47 Compact black chairs
- 90 New black chairs
- 8 High stools

### PLATFORMS

(Height | Length x Width | Amount)

- 20 cm | 2 x 1 m | 5
- 40 cm | 2 x 1 m | 9
- 40 cm | 1 x 1 m | 1

- 60 cm | 2 x 1 m | 10
- 80 cm | 2 x 1 m | 10

- 8 large platforms for Cello
- Width: 60 cm
- Length: 123 cm
- Height: 17 cm

- 22 small platforms for violin
- Width: 60 cm
- Length: 90 cm
- Height: 17 cm

- 1 platform for harp

### CONDUCTOR'S PODIUMS

- Width: 1 m
- Length: 90 cm
- Height: 35 cm
- Width: 82 cm
- Length: 71 cm
- Height: 78 cm

### LIGHTING

- Mesa de Iluminação ETC ION
- Plugues padrão PTV

### VARAS DE ILUMINAÇÃO

- 5 electric bars – 14 channels per bar, maximum weight 300kg
- 1 proscenium – 17 channels
- 2 front – 16 channels (cake) 4 channels (cabin)
- 4 lateral bars (8 attachments and 4 channels)

### LIGHTING EQUIPMENT ITEMS

- 2 1200w Light cannons
- 12 ETC 36° Source Four Ellipsoidal spotlights
- 14 ETC 19° Source Four Ellipsoidal spotlights
- 5 ETC 10° Source Four Ellipsoidal spotlights
- 3 ETC 5° Source Four Ellipsoidal spotlights
- 33 Plano-Convex Lenses
- 20 Fresnel lenses
- 26 Set lights
- 38 PAR focus 5 light bulbs
- 17 PAR focus 2 light bulbs
- 5 PAR focus 1 light bulbs

### ACCESSORIES FOR REFLECTORS

- 20 Gobo Holders
- 10 irises for ellipsoidal spotlights

### AUXILIARY EQUIPMENT ITEMS

- 8 towers - height 3m
- Extensions 1 x 16m, 1 x 10m, 1 x 8m, 15 x 6m, 9 x 4m, 12 x 3m
- 25 parallels
- 5 PTV female adapters for male PIAL
- 15 PTV male adapters for female PIAL
- 10 DMX 4-channel decoders for simple LED strip with up to 10m

**Note:** Theatro São Pedro does not have gelatins, smoke machine, hazer or generator.

### SOUND

#### CONSOLE

- 01 YAMAHA 01V96 mixer. With no expansion board and no external amplifier
- 01 YAMAHA MG 20XU analog mixer (backup)
- P.A.
- P.A. With 2 Stage Accompany E24 reference cabinets

**Note:** P.A. does not support concerts

#### MONITORS

- 4 Stage Accompany Leader L24 passive stage monitors (1 fixed)
- 2 Stage Accompany E24 Entertainer series passive reference monitors
- 1 YAMAHA DXR15 amplified cabinet

#### AMPLIFIERS

- 3 HotSound HS AUDIO 2800 stereo amplifiers for monitoring (1 used on P.A.)
- 2 Stage Accompany SA2310 stereo graphic equalizers (31 bands)
- 3 DI WHIRLWIND IMP2 DirectBox (passive)

#### MICROPHONES AND STANDS

- 2 SHURE SLX24/ BETA58 wireless microphones (super-cardioid)
- 1 JTS NX8 dynamic microphone (cardioid)

- 1 Behringer XM8500 dynamic microphone (cardioid)
- 4 RODE Nt1 condenser microphones (cardioid)
- 7 black microphone stands, “giraffe” model
- 14 chrome microphone stands, “non-giraffe” model

**Note:** Theatro São Pedro has excellent acoustics. For amplification of concerts and events, the maximum limit allowed is 90 decibels.

### TECHNICAL STAFF WORK HOURS

Monday to Friday, 8 AM to 11 PM, split in 2 shifts:

- From 8 AM to 5 PM, with lunch break from 1 PM to 2 PM or to be discussed.
- From 2 PM to 11 PM, with dinner break from 6 PM to 7 PM or to be discussed. Reminding that the set assembly time is from 8:30 AM to 10:30 PM due to the venue’s opening and closing procedures.
- According to the theater’s calendar and the needs from each performance, the staff may be scheduled to work in only one of the shifts.





# RULES AND PROCEDURES

## **STAGE AND MAIN FLOOR RULES**

CAMERAS, MOBILE PHONES, FOODS AND BEVERAGES ARE NOT ALLOWED ON THE STAGE, WING AND MAIN FLOOR

The presence and use of cameras and mobile phones is forbidden in the stage, wing and main floor areas, because they interfere with the intercommunication by the technical staff. Using these devices is only allowed in the dressing room area. Drinking and eating any type of food, including candy and bubble gum, is also only allowed in the dressing room area. Drinking water on stage is allowed provided it is from a capped bottle.

## **KEEP YOUR BELONGINGS IN THE LOCKERS**

To facilitate the organization of rehearsals and ensure the safety of personal objects, Teatro São Pedro offers lockers for you to keep your belongings. Please bring a padlock.

## **IT IS FORBIDDEN TO LEAVE BACKPACKS, SHOES AND PERSONAL OBJECTS ON THE STAGE, WING AND MAIN FLOOR**

Use only what is strictly necessary for your work on the stage and main floor.

## **YOU CANNOT GO TO THE MAIN FLOOR OR LEAVE THE THEATER'S FACILITIES IN COSTUMES**

Do not go to the main floor or leave the theater's facilities wearing the performance or rehearsal costume.

## **DO NOT SIT ON SCENIC OBJECTS OR THE THEATER'S STRUCTURES**

We also kindly ask you to not wait for entering scene sitting or leaning on scenery items or theater

structures. In addition to soiling or damaging the costume, this may interfere with the show's operation. On the main floor, please don't sit on the chair arms or put your feet on the seats.

## **DO NOT USE STAGE SOCKETS WITHOUT AUTHORIZATION**

Stage sockets can only be used according to guidance from the technical staff.

## **DO NOT PLACE OBJECTS ON THE PIANOS AND DO NOT USE MUSIC INSTRUMENTS WITHOUT AUTHORIZATION**

Do not lean on or place objects on the pianos. We also ask you to not use any music instrument without authorization.

## **ASSEMBLIES AND DISASSEMBLIES: CIRCULATING ON THE STAGE**

As a safety measure, we inform all departments that, during the assembly and disassembly period, the access via Rua Barra Funda must be preferably used. Whenever possible, we will maintain an aisle to walk through the stage, which will be duly signposted.

## **WEARING SHOES IS MANDATORY**





For everyone's safety, it is mandatory to wear shoes on stage during the assembly and disassembly period. It will not be permitted to circulate or rehearse wearing sandals or barefoot.

## **IT IS MANDATORY TO USE PPE**

During the assemblies, disassemblies and works that involve risks, it is mandatory to use personal protective equipment items.





-  /theatrosaopedro
-  /theatrosaopedro
-  /thesaopedro
-  /TheatroSaoPedroTSP